

Arrival Procedures:

Busses Transportation– Arrive at the bus stop at 8:15 am, the busses leave promptly at 8:30 am. Staff will sign camper in as they get on the bus. Parents/guardians must stay with their campers at the bus stop until they get on the bus.

Drop off – Parents/guardians will stay in their cars and follow the traffic pattern. A staff member will approach the car when it is time for the camper to get out. Staff will direct camper where to go.

Dismissal Procedures:

At dismissal, give your name to the staff member and let them know which campers you are picking up. Staff will check to ensure you are authorized to pick up and check your camper(s) out for the day using the APP

To add Authorized Pick Ups to your account:

Step 1: Download the Playerspace 2.0 App & log in (same credentials from uploading the health forms)



Step 2: Add all authorized pick-ups for your camper (ex. Parent/guardian, grandparent, friends/carpool families, etc.)

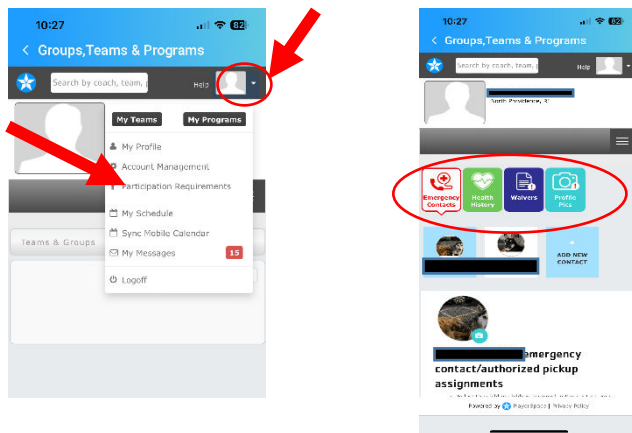

**Please be patient with us as we learn to use this new system! Check out may take longer in the first few days of each session as we get used to this.*

Picking up at Camp Ramsbottom: Pickup begins at 4:15, cars will not be let into the parking lot until 4:05 to allow time for busses to leave. Please do not come early!

Early Dismissal Procedures:

- Parents/guardians requesting early dismissal must send a note to the Camp office (camper can give the note to their counselor). You MUST sign you're your child out in the office before leaving Camp.
- Early dismissals must be before 3:00 pm!